

THE

# BRANNIGANZ

SERVICED SUITES

BUKIT BINTANG KL



NEW AGE INGENUITY



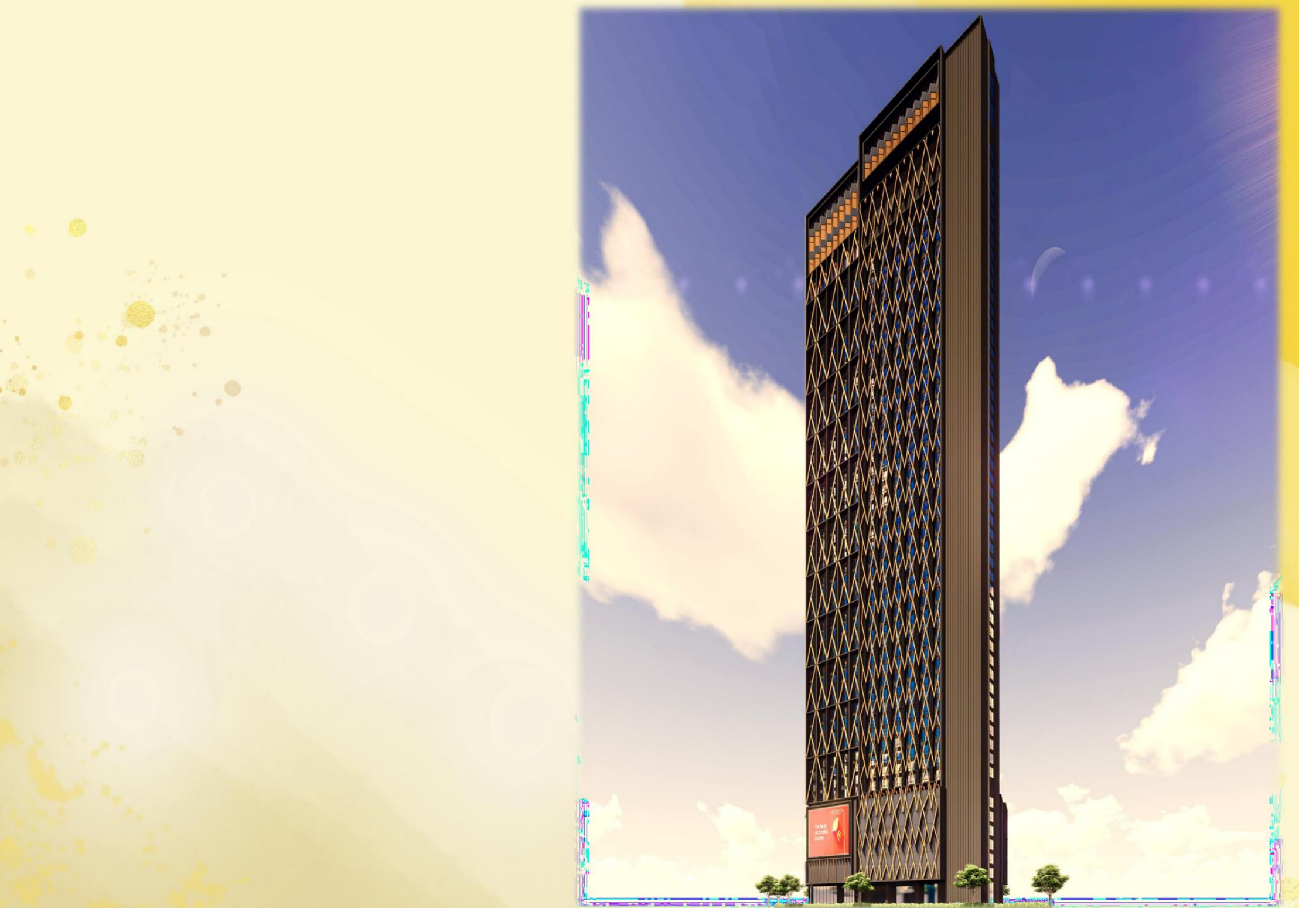





POOL DECK & SWIMMING  
POOL



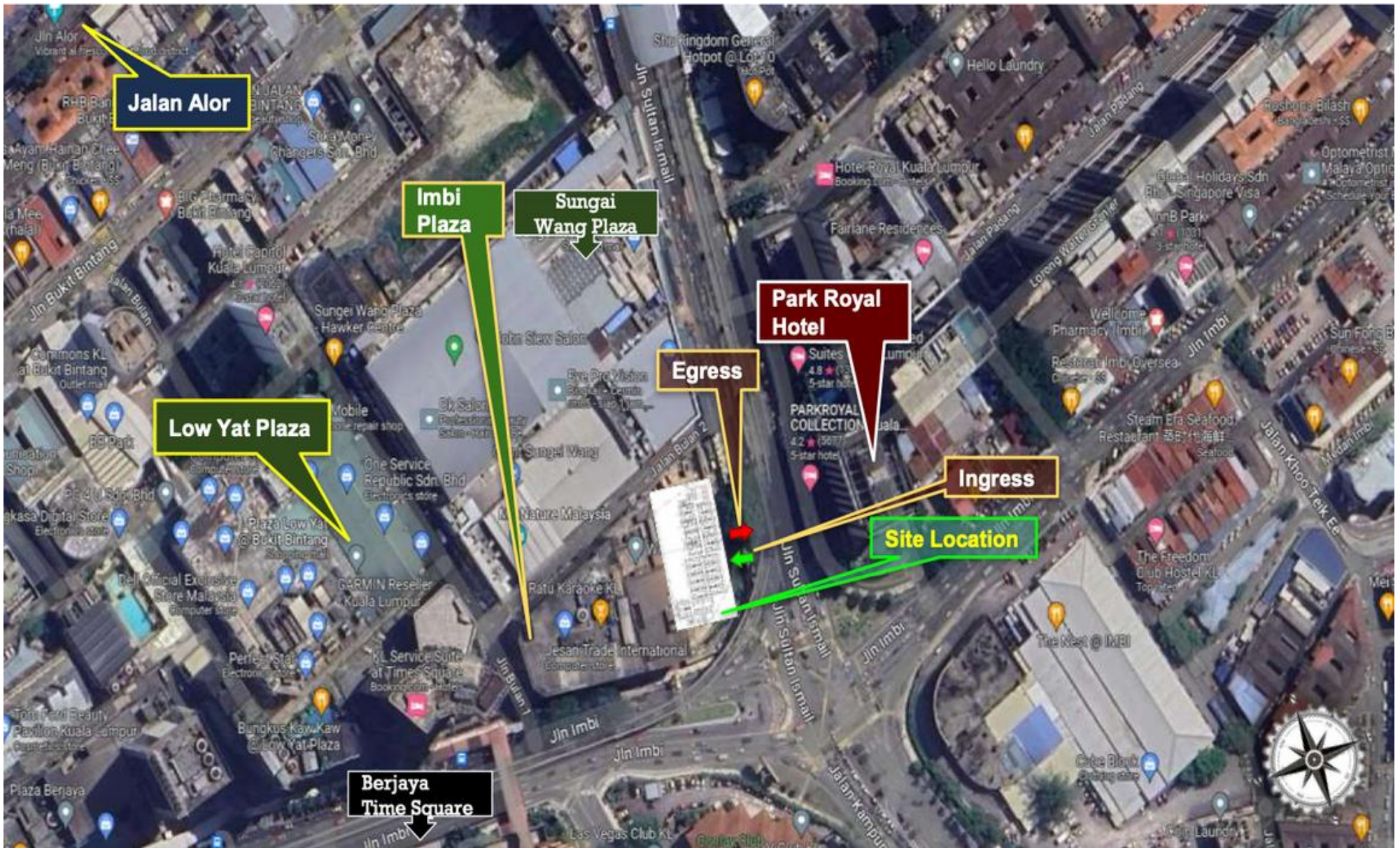

DRAFT 01

600 ft



Imbi station

Bukit Bintang station

Berjaya Times Square

Sg Wang

We're here!







600 ft  
300 ft



DRAFT 01

600 ft

300 ft





# Walking Distance to 5 Shopping Malls

- Pavillion Bukit Bintang
- Lot 10
- LalaPort
- TRX Mall
- Sg Wang
- Time Square

# W Kuala Lumpur

Website

Directions

Save

Call

4.7 ★★★★★ 3,767 Google reviews

5-star hotel

CHECK AVAILABILITY

**Address:** 121, Jalan Ampang, Kuala Lumpur, 50450 Kuala Lumpur, Wilayah Persekutuan Kuala Lumpur

**Phone:** 03-2786 8888

## Compare prices

Wed, 10 May

Thu, 11 May

2

## Sponsored · Featured options

 W Kuala Lumpur Official website **RM 1,107** >

2 guests · Free cancellation

3 guests · Free cancellation **RM 1,314** >

4 guests · Free cancellation **RM 1,526** >

 Agoda **RM 1,102** >

Free cancellation until May 9

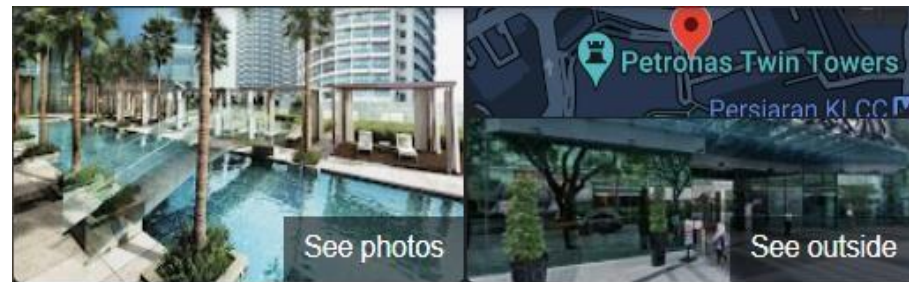

See photos

See outside

# Four Seasons Hotel Kuala Lumpur

Website

Directions

Save

Call

4.6 ★★★★★ 3,861 Google reviews

5-star hotel

CHECK AVAILABILITY

**Located in:** KLCC Park

**Address:** 145, Jalan Ampang, Kuala Lumpur, 50450 Kuala Lumpur, Wilayah Persekutuan Kuala Lumpur

**Phone:** 03-2382 8888

Save **RM 534** if you stay Thu, 11 May–Fri, 12 May

## Compare prices

Wed, 10 May

Thu, 11 May

2

## Sponsored · Featured options

 Agoda **RM 1,536** >



Superhost

Apartment in Kampung... ★ New  
KL Tower View / Scarletz ...  
1 bed

RM327 RM293 night · RM358 total

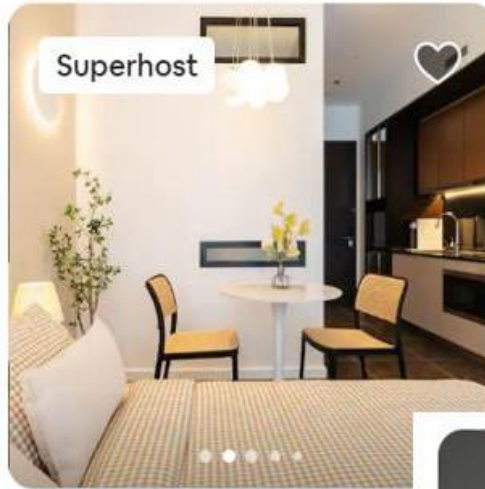

Superhost

Apartment in Kamp... ★ 4.  
Bath Tub KLC French Roma  
1 bed

RM297 night · RM362 total



Apartment in Titiwa... ★ 4.67 (6)  
[HOT!] KLCity Deluxe Suite w ...  
1 bed

RM356 night · RM356 total



Superhost

Apartment in Kampung Bahru  
KL Tower View/Scarletz ...  
2 beds

RM358 RM270 night · RM330 total



Apartment in Kampu... ★ 5.0 (4)  
Scarletz 1-4pax · PremiumSuite...  
2 beds

RM270 night · RM335 total

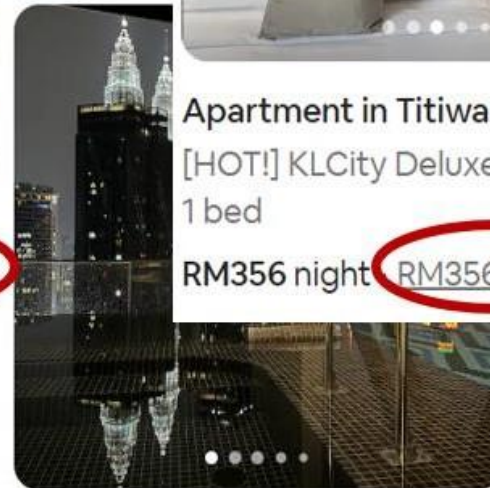

Apartment in Kampu... ★ 4.5 (6)  
Luxury serviced apartment sky-...  
2 beds

RM244 night · RM344 total

Avg Daily Rate RM 335

# 344SF | From RM 3.4k/mth

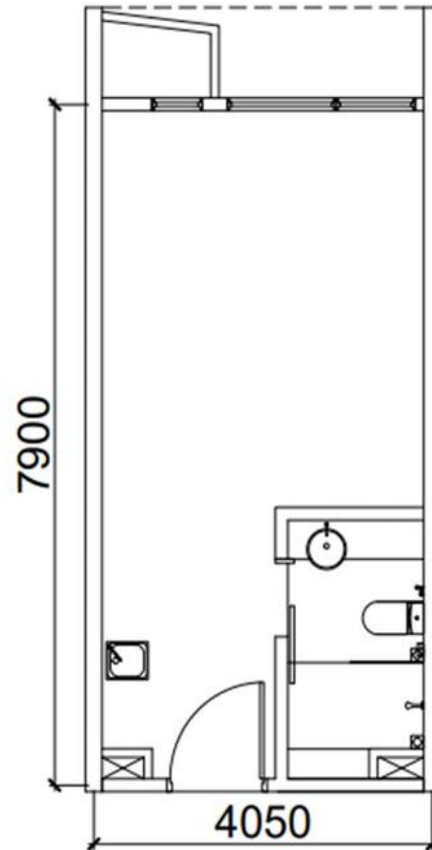

# 495SF (2Bedroom) | From RM 4.5k/mth

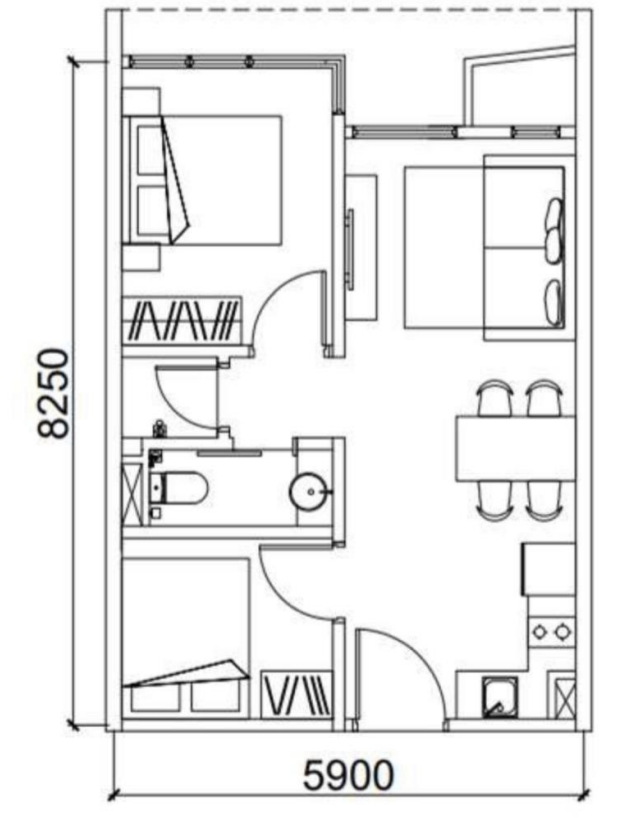

# 678SF (Dual key) | From RM 6k/mth

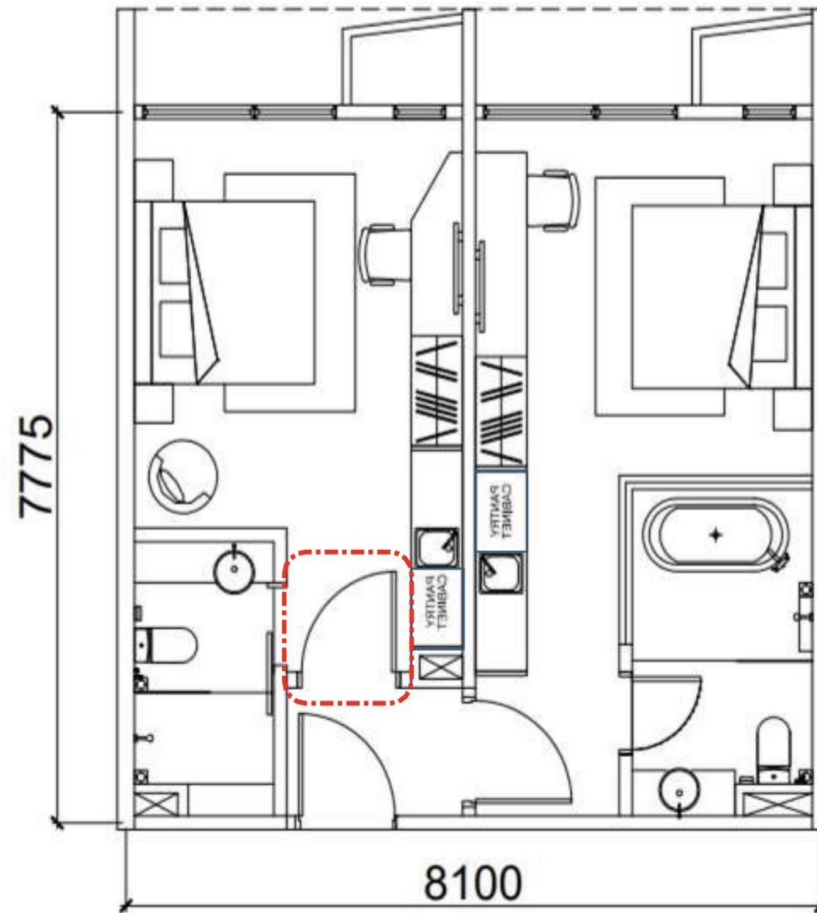

 DUAL KEY RENOVATION PLAN



# Project Info

<b>Total Unit</b>	<b>759 units</b>
Building Heights	<b>51 storeys</b>
Type Unit	<b>344sf (studio), 495sf (2-room), 678sf (dual key)</b>
Nett price	<b>344sf - 747k , 495sf - 1.06m &amp; 678sf - 1.36m</b>

# Facility

<b>Sky Conference Hall</b>	<b>Sky Pool</b>
Sky Lounge	Sky Chill Deck
Sky Gym	Alfresco
Sky Dining	Co-Working Lounge
Sky Garden Deck	Garden Lounge
Sky Courtyard Garden	Sky Pool Dining Lounge

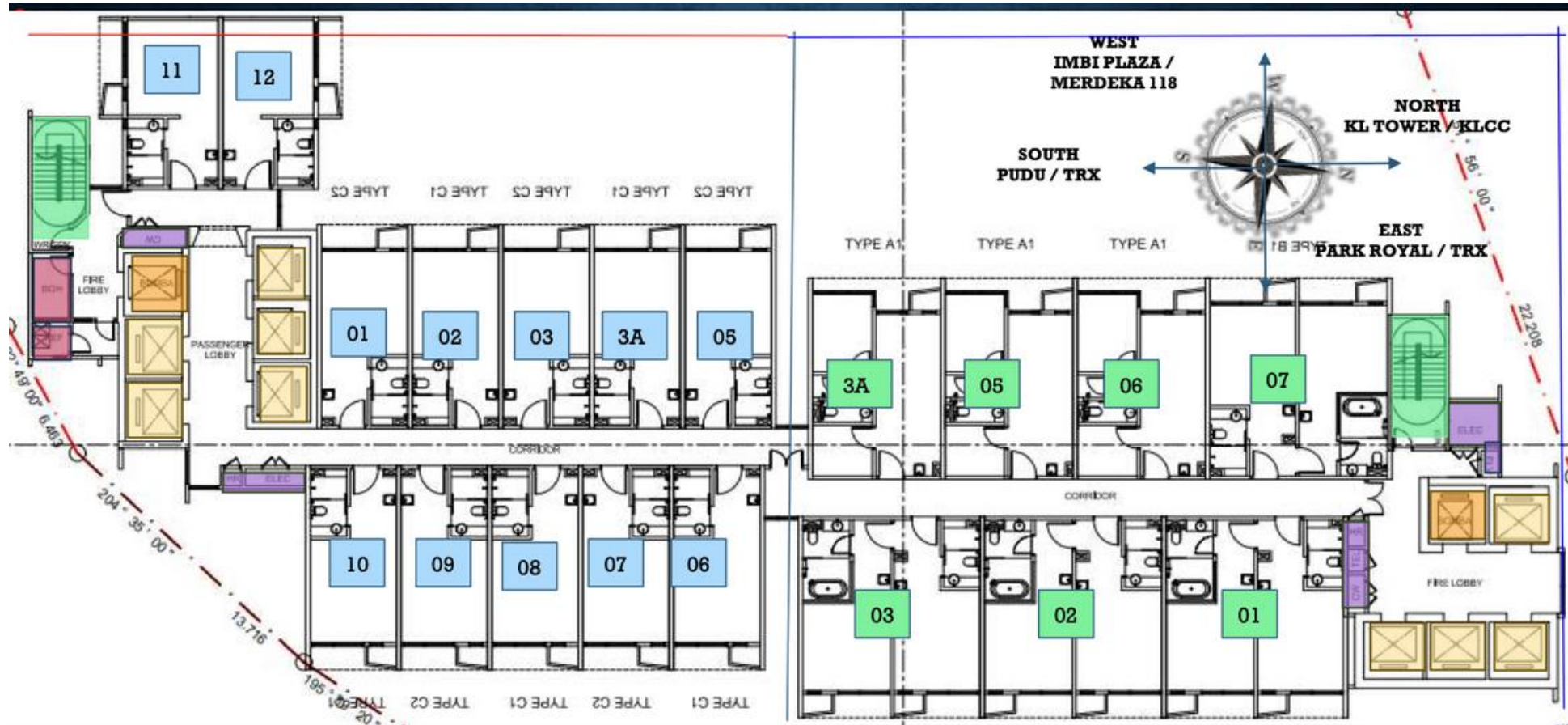

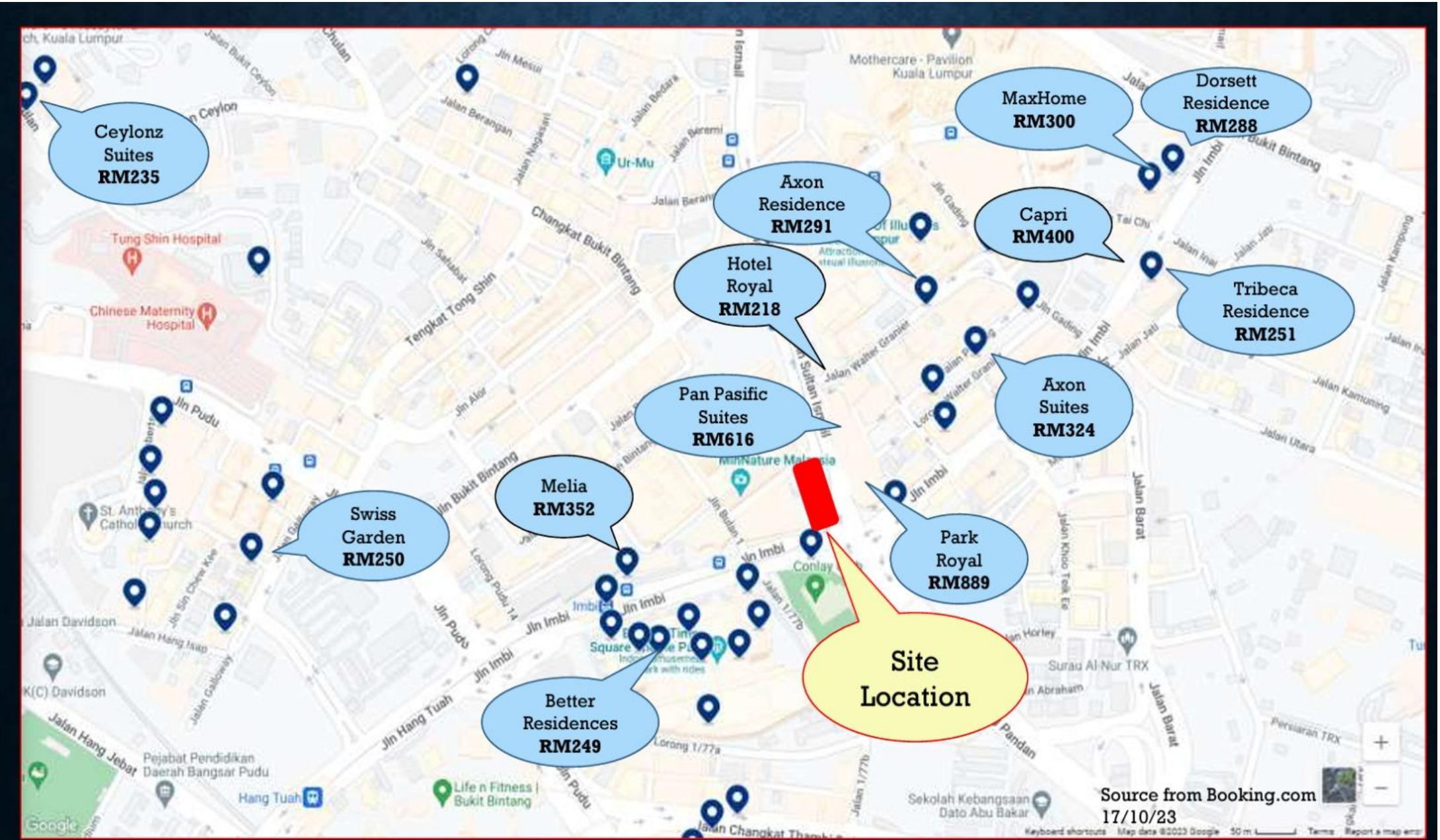

Source from Booking.com  
17/10/23